

LUFKIN PARK SITE PLAN		
JOB NO. 205.178	APPROVED BY: <i>R.M.H.</i>	DATE 17 MAY 76
DRAWN BY: D.C.A.	REVISOR BY:	DATE
SCALE: 1" = 30'	REVISOR BY:	DATE
<b>RALPH F. GROSS &amp; SON, ASSOC. INC.</b>		
VILLA PARK, ILL.		DRAWING NUMBER 1 OF 1

**POOL SITE PLAN:**

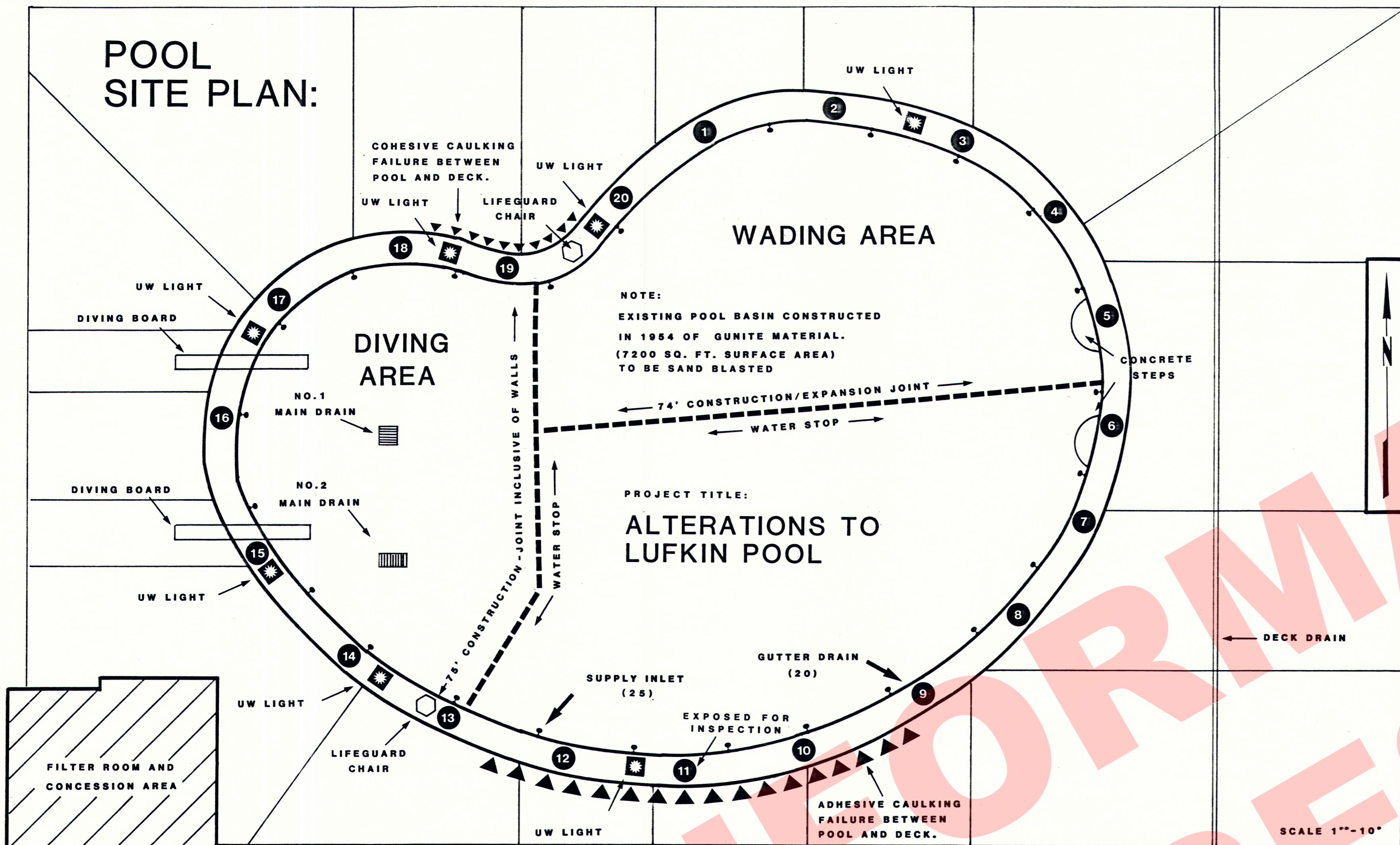

NOTE:  
EXISTING POOL BASIN CONSTRUCTED IN 1954 OF GUNITE MATERIAL. (7200 SQ. FT. SURFACE AREA) TO BE SAND BLASTED

PROJECT TITLE:  
**ALTERATIONS TO LUFKIN POOL**

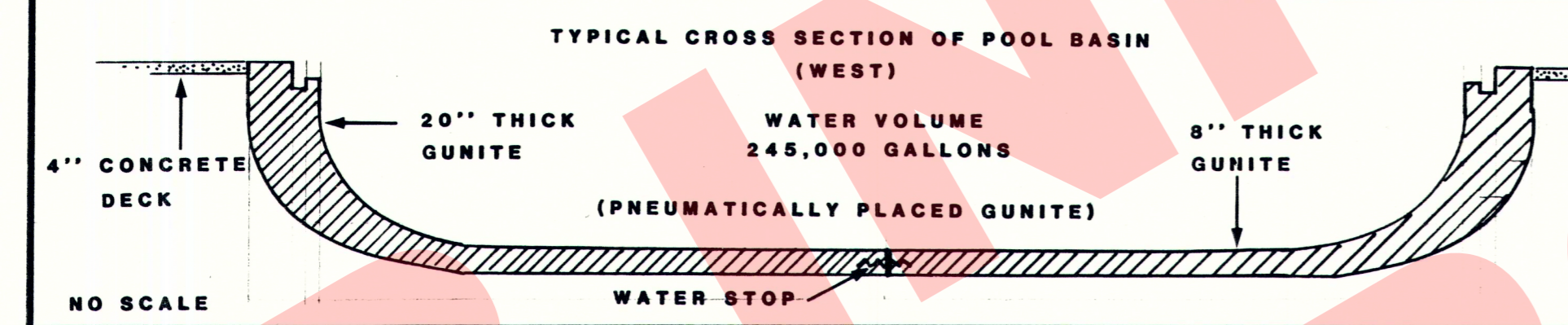

NOTE:  
QUALITY AND THICKNESS OF CONCRETE CORE SAMPLES TAKEN ON 10-16-75 AT SHALLOW END OF THE POOL AND TESTED 3500-7500psi. UP TO 3/4" DIAMETER REINFORCING STEEL OBSERVED AND HEAVY REINFORCING INDICATED.

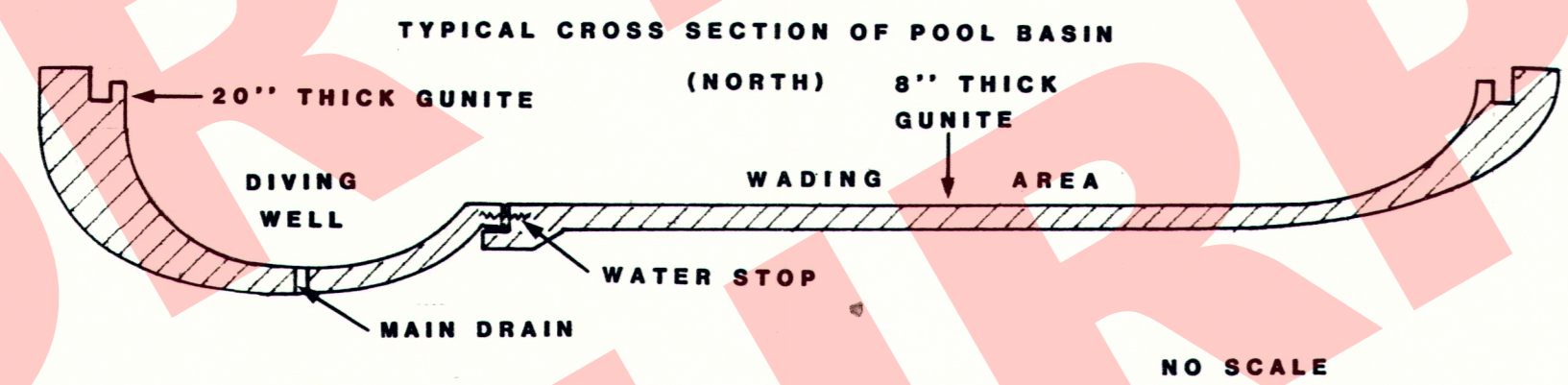

FACILITY:  
**LUFKIN SWIMMING POOL**  
1000 S. ARDMORE  
VILLA PARK, ILLINOIS

**OWNER:**  
VILLAGE OF VILLA PARK  
PARK & RECREATION DEPT.  
20 S. ARDMORE  
VILLA PARK, ILLINOIS  
60181

**GENERAL NOTES:**

THE AS-BUILT CONDITIONS AND FIELD MEASUREMENTS AS SHOWN ON THIS DRAWING AND REFERENCED IN THE PROJECT SPECIFICATIONS ARE INTENDED TO REPRESENT THE EXISTING FIELD CONDITIONS AT LUFKIN POOL FACILITY. EACH BIDDER IS HOWEVER CAUTIONED TO INVESTIGATE THE EXISTING CONDITIONS AND TAKE SUCH MEASUREMENTS AS HE DEEMS NECESSARY TO ASCERTAIN THE CORRECTNESS AND COMPLETENESS OF THE AS-BUILT DOCUMENTS.

NEITHER THE VILLAGE BOARD NOR THE PREPARER OF THESE DOCUMENTS CERTIFIES THAT THE AS-BUILT DOCUMENTS REPRESENT THE TOTAL CONDITIONS WHICH MAY BE ENCOUNTERED IN THE COURSE OF THE WORK. BIDDERS ARE CAUTIONED THAT CONDITIONS, ESPECIALLY THOSE COVERED BY EXISTING WORK, MAY VARY FROM THE CONDITIONS AS DOCUMENTED AND AS SUCH, ALL BIDDERS ARE ADVISED TO VERIFY ALL DIMENSIONS AND FIELD CONDITIONS WHICH MAY AFFECT THEIR WORK ON THIS PROJECT.



DRAWING PREPARED BY: *Wayne L. Lulay*  
WAYNE L. LULAY, DIRECTOR

**DETAIL —A (GUTTER DRAIN ALTERATIONS)**

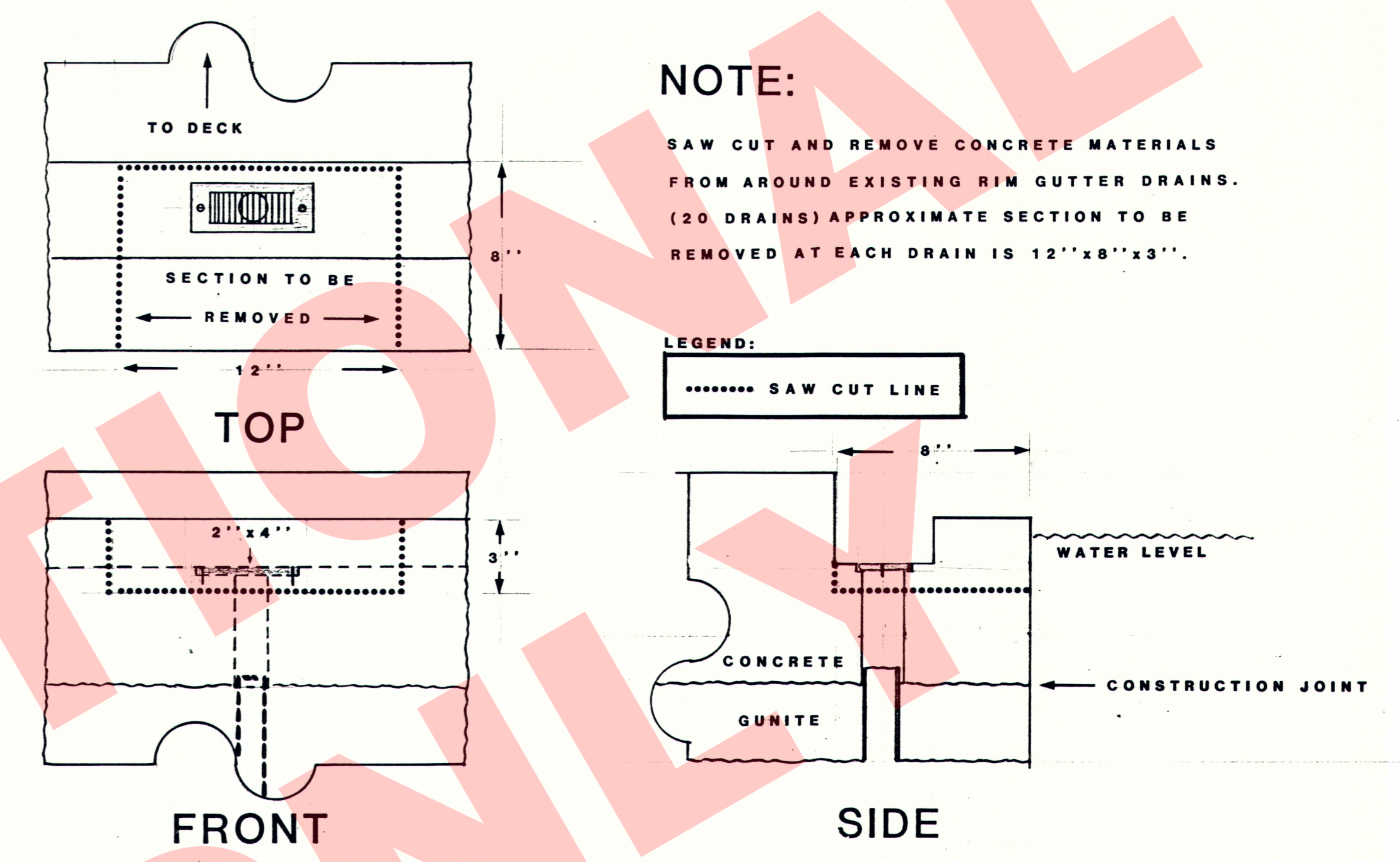

**DETAIL —B (GRATE AND EXTENDER CONNECTION)**

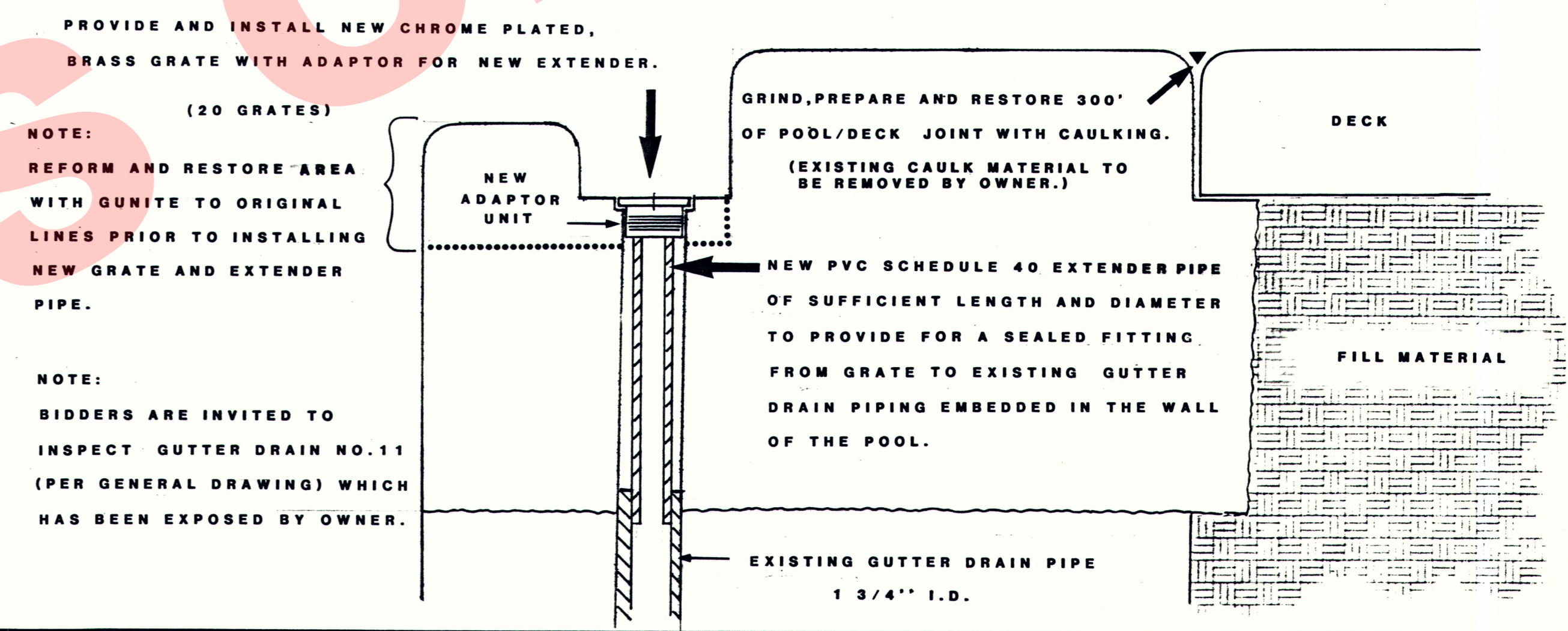

**DETAIL —C (JOINT RESTORATION)**

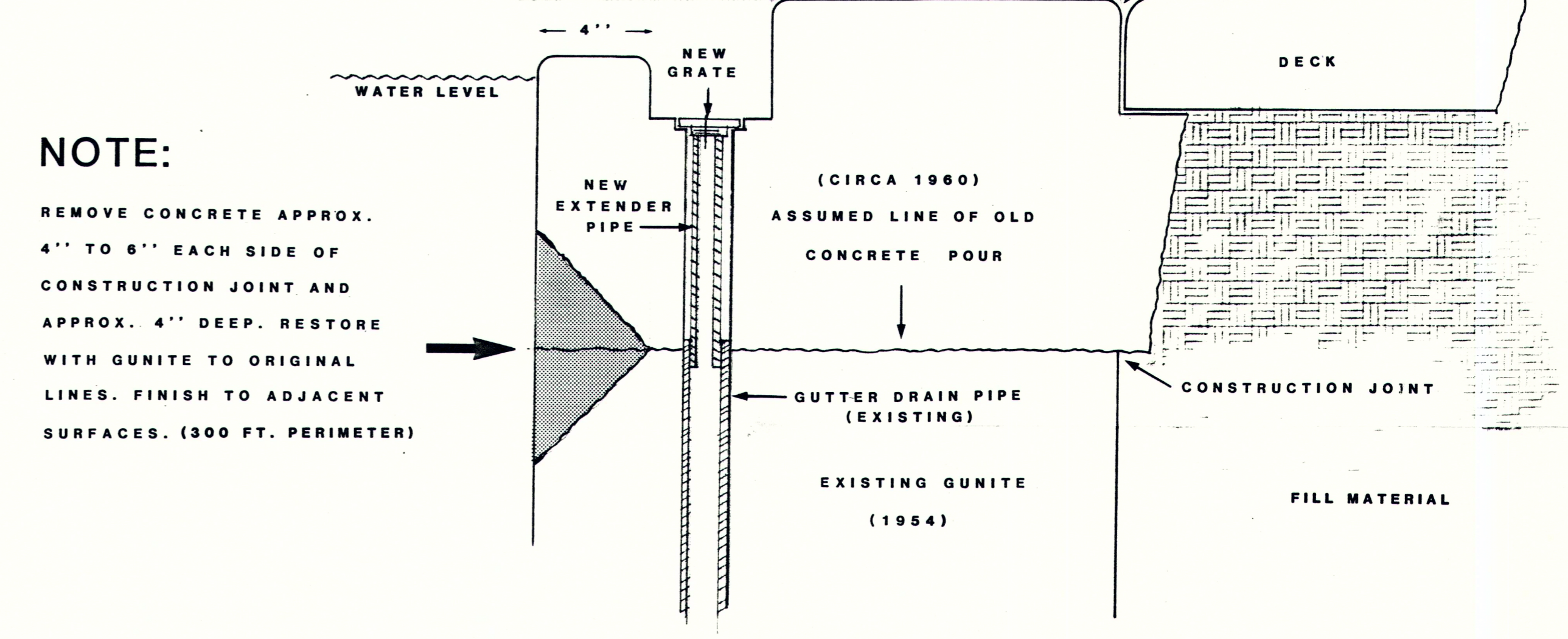

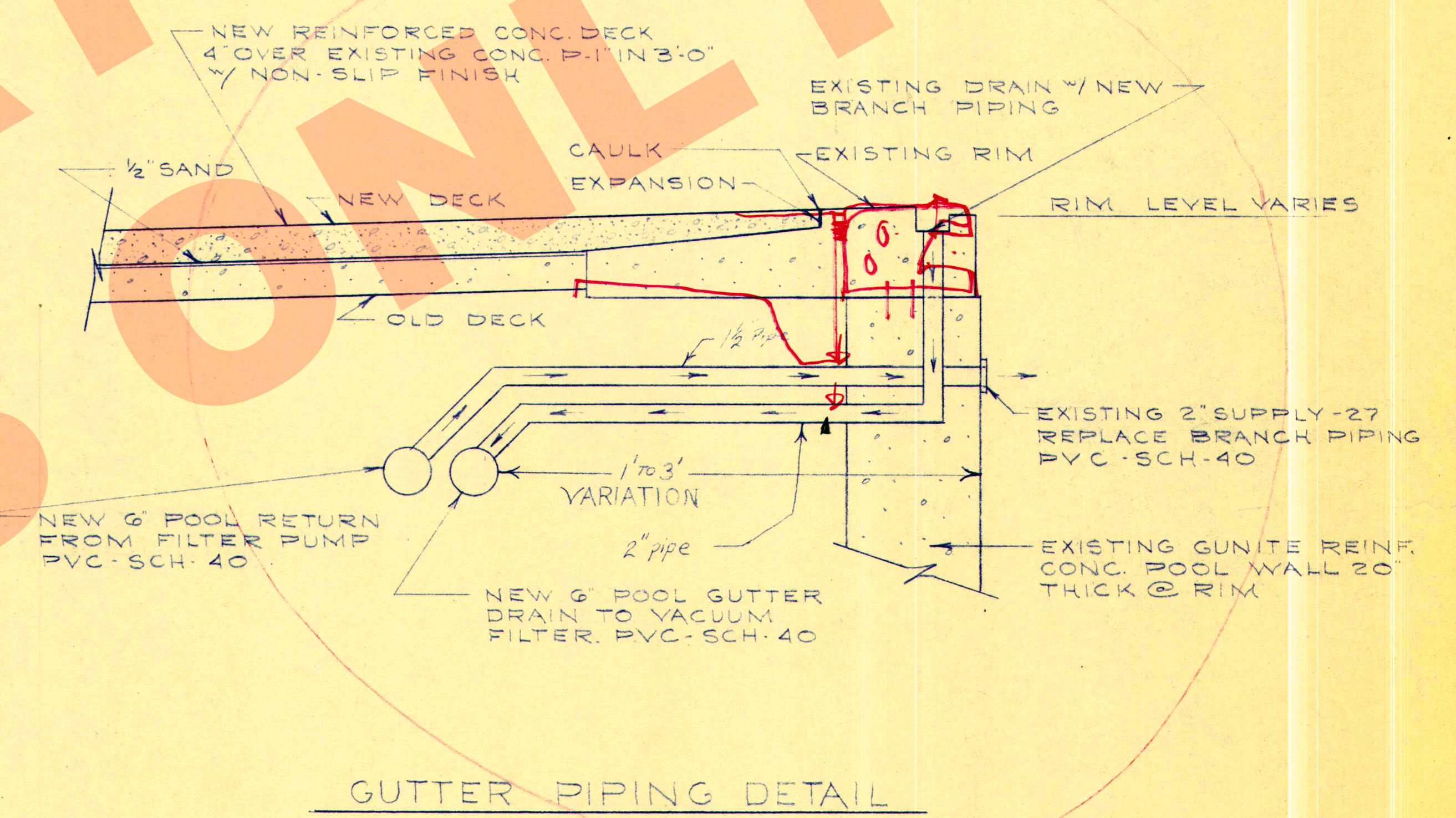
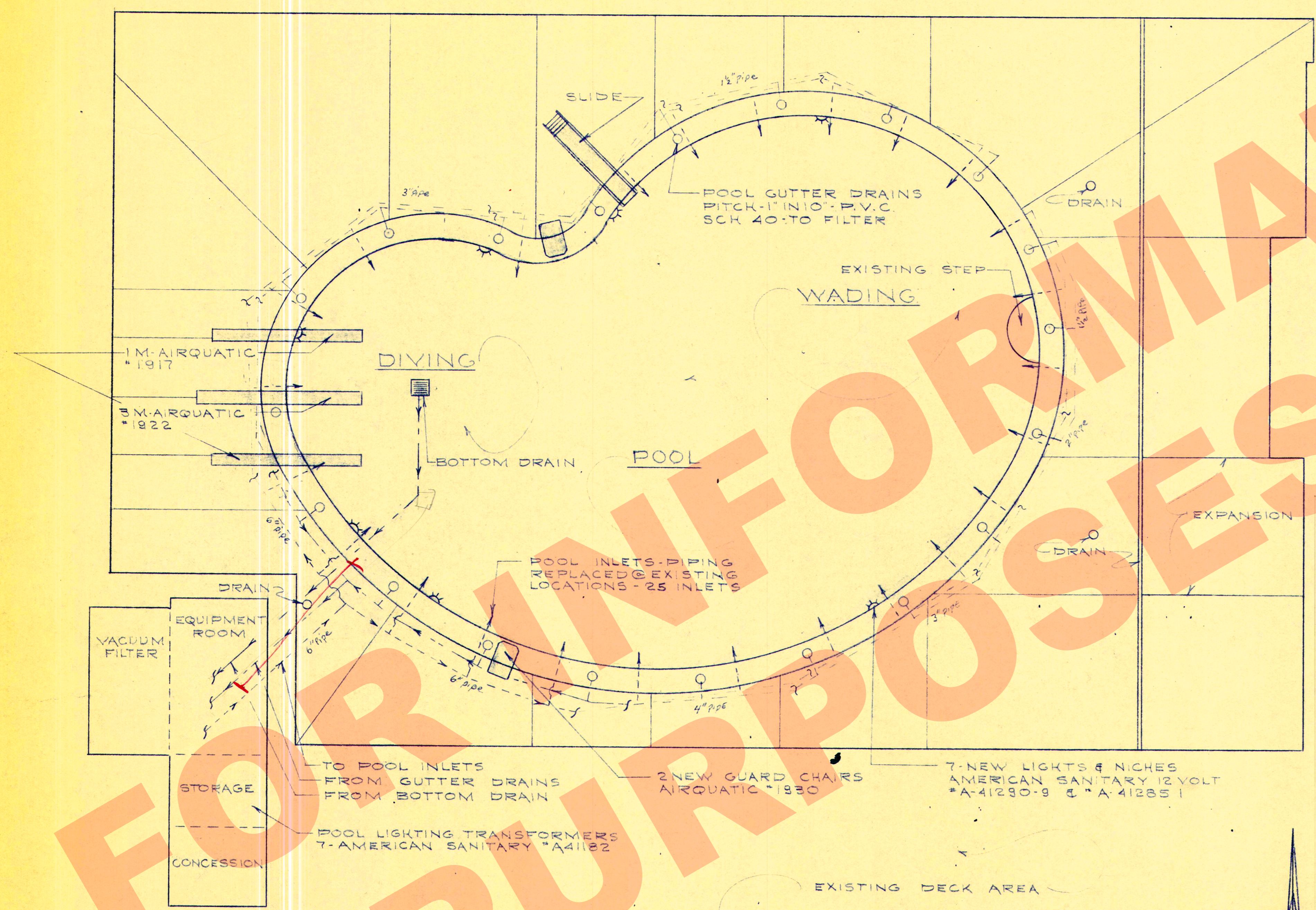
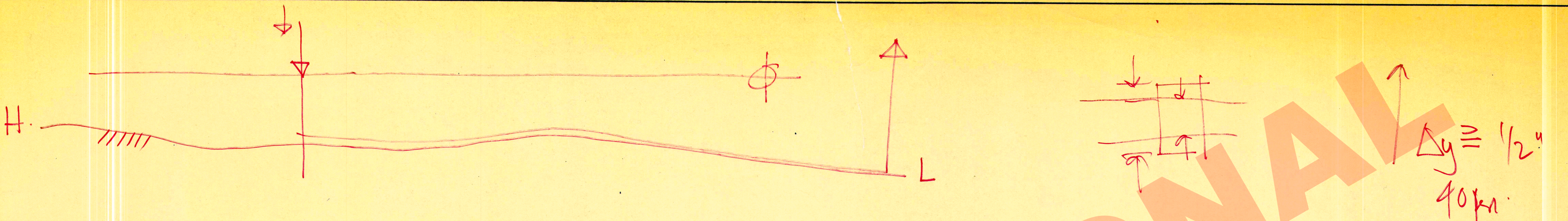

LUFKIN SWIMMING POOL

VILLAGE OF VILLA PARK RECREATION BOARD 320 EAST WILDWOOD AVE - VILLA PARK, TX		
SCALE: NONE	APPROVED BY:	DRAWN BY:
DATE: 1976		REVISED:
POOL ALTERATIONS		
LAFLUER POOL SERV. INC.		DRAWING NUMBER:

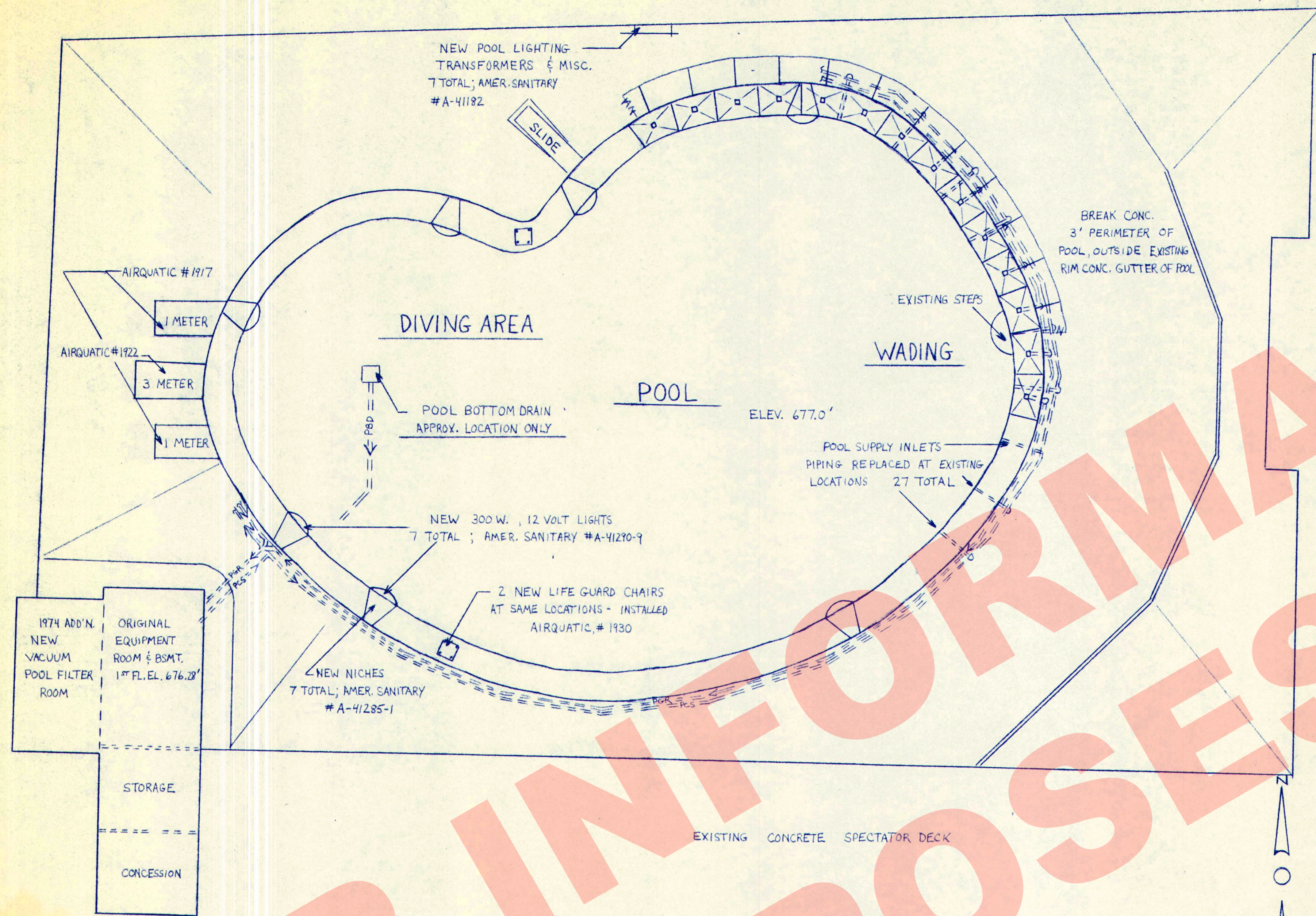

**LEGEND**

- == PDS == POOL CHLORINATED SUPPLY WATER
- == PGR == POOL GUTTER RETURN WATER
- == PBD == POOL BOTTOM DRAIN RETURN WATER

POOL AND POOL DECK PLAN  
SCALE: 1" = 10'-0"

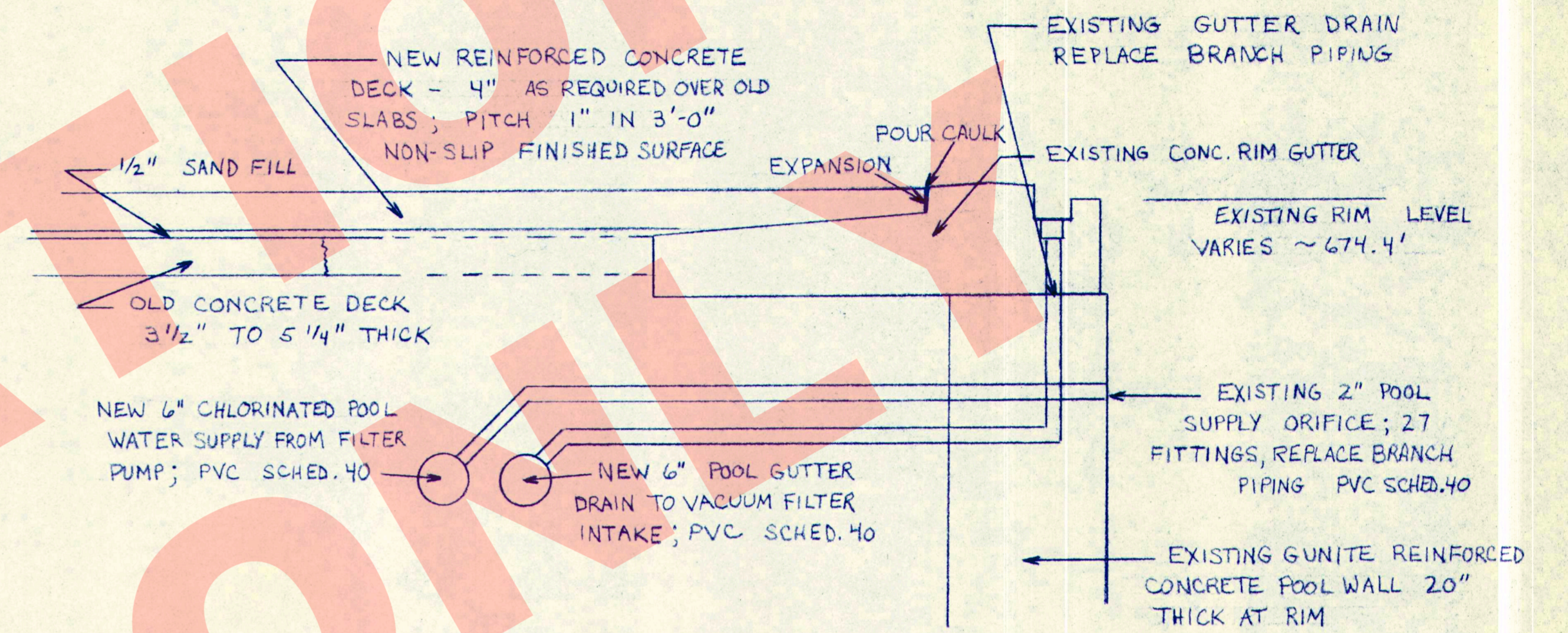

SECTION ELEVATION - PIPE ACCESS  
SCALE: 3/4" = 1'-0"

FOR INFORMATIONAL PURPOSES ONLY

LUFKIN SWIMMING POOL	
FOR: VILLAGE OF VILLA PARK RECREATION BD.	
320 EAST WILDWOOD AVE. VILLA PARK, ILL. 60181	
POOL, POOL DECK, AND PIPING PROPOSED SYSTEM ALTERATIONS	
SCALE AS NOTED	DATE: JAN. 27, 1976

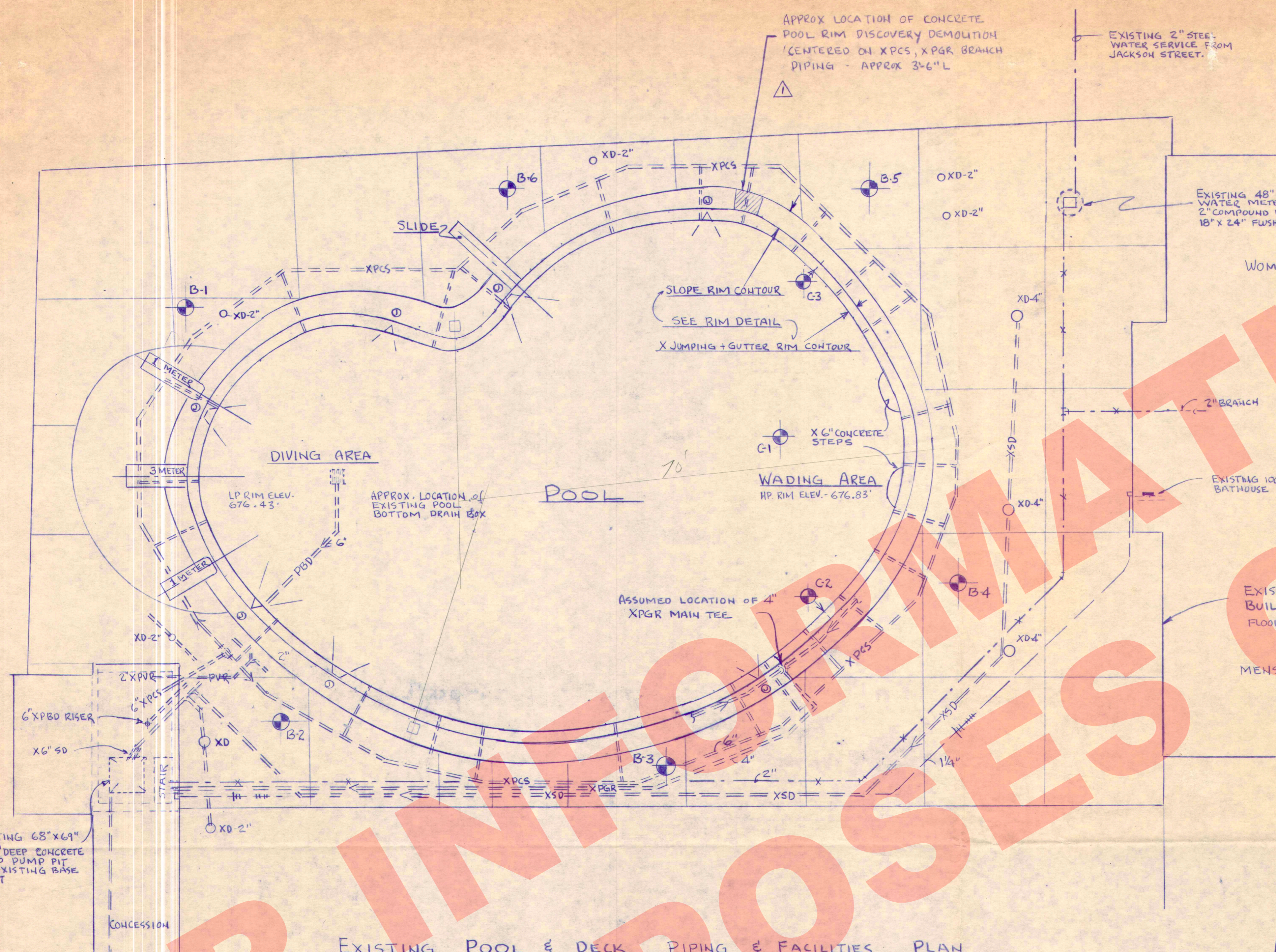

EXISTING POOL & DECK PIPING & FACILITIES PLAN  
SCALE @ 1" = 10'-0"

NOTE: ALL PIPING ROUTES INDICATED ARE NECESSARILY TENTATIVE & APPROXIMATE BASED ON OBSERVATION AT EXPOSED TERMINATIONS & REPORTS OF PREVIOUS REPAIRS

PIPING & SYMBOL LEGEND

	POOL CHLORINATED WATER SUPPLY	SCHED 40 BLACK STEEL		EXISTING SANITARY/STORM WATER DECK DRAINS
	POOL RIM GUTTER LEVEL RETURN	" " " "		B-1 THRU 6 DECK AREA SOIL BORINGS
	POOL BOTTOM LEVEL DRAIN RETURN	" " " "		C-1 THRU 3 POOL WALL/FLOOR TEST CORES
	POOL VACUUM CLEANING RETURN	" " " "		"X" PREFIX DESIGNATES EXISTING FACILITIES
	DECK LEVEL SANITATION & STORM WATER DRAIN	" " " "		
	SUMP PUMP DISCHARGE	" " " "		
	DOM. CITY WATER SUPPLY (50-60 PSIG)	" " " "		
	2" PCS SUPPLY INLET	" " " "		
	400 W 120V UNDERWATER LIGHT FIXTURE & JUNCTION BOX			
	1000 W " " " " " " " "			
	ELECTRICAL FEEDER CONDUIT	HEAVY WALL GALV. STEEL		

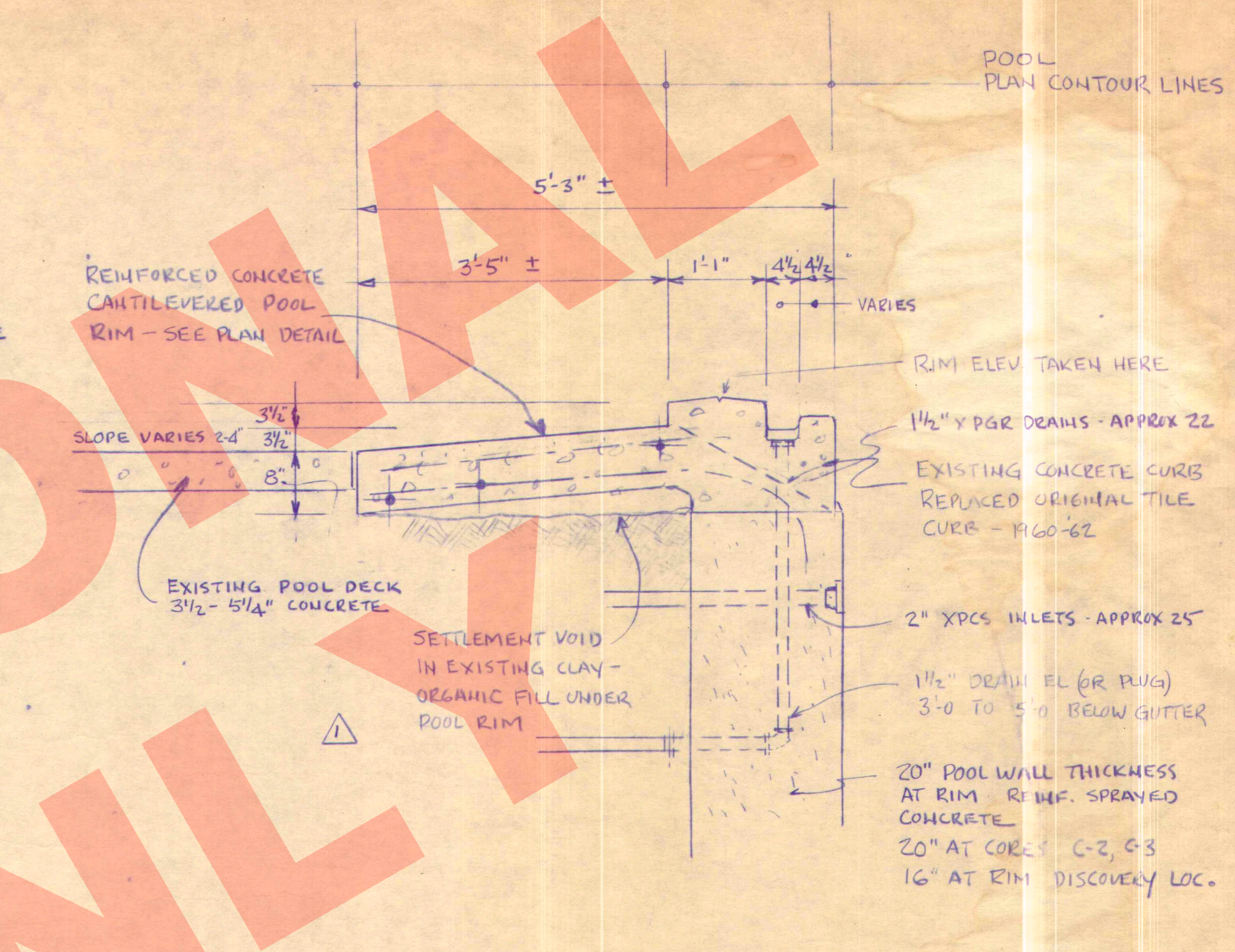

SECTION THRU EXISTING POOL RIM CONST.  
SCALE @ 3/4" = 1'-0"

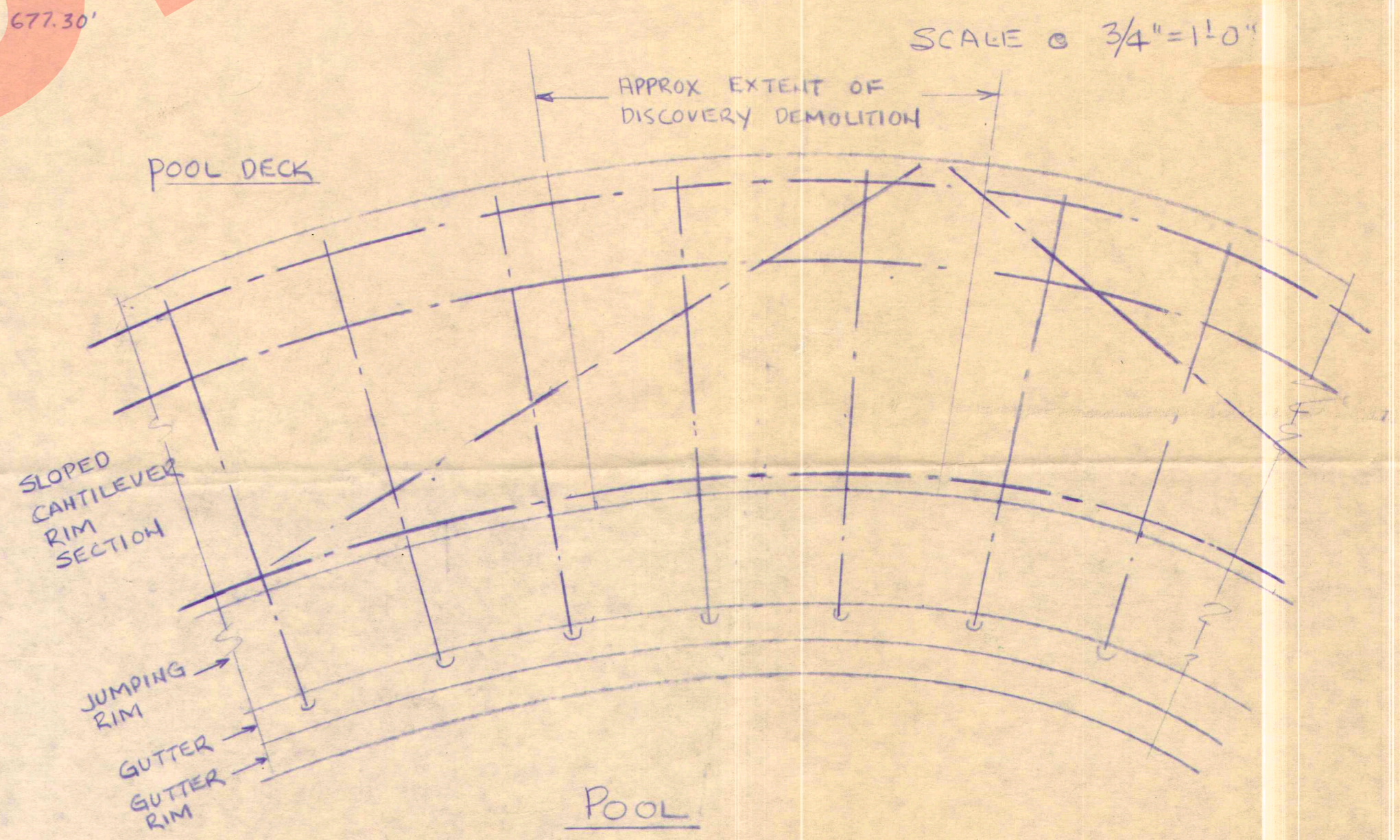

DETAIL PROJECTED PLAN FOR CANTILEVERED CONCRETE POOL RIM REINFORCING STEEL  
SCALE @ 3/4" = 1'-0"

INDICATES #4 DEFORMED STEEL BARS (1/2" Ø)

SCALE AS NOTED	LUFKIN SWIMMING POOL - ALTS.	PROJECT NO. 433-75
DRAWN BY RDM	for VILLAGE of VILLA PARK RECREATION BOARD	DATE 11/15/75
CHECKED BY	320 EAST WILDWOOD AVENUE VILLA PARK, ILL. 60181	SHEET NO.
REVISIONS	POOL, POOL DECK & PIPING	
MARK DATE	EXISTING FACILITIES	
Δ 1/9/76 RIM CONST.		
RICHARD O. MITTER & ASSOCIATES CONSULTING ENGINEERS		R-2
KENILWORTH & MORTON DO 218 VILLA PARK ILLINOIS 312 834-4762		

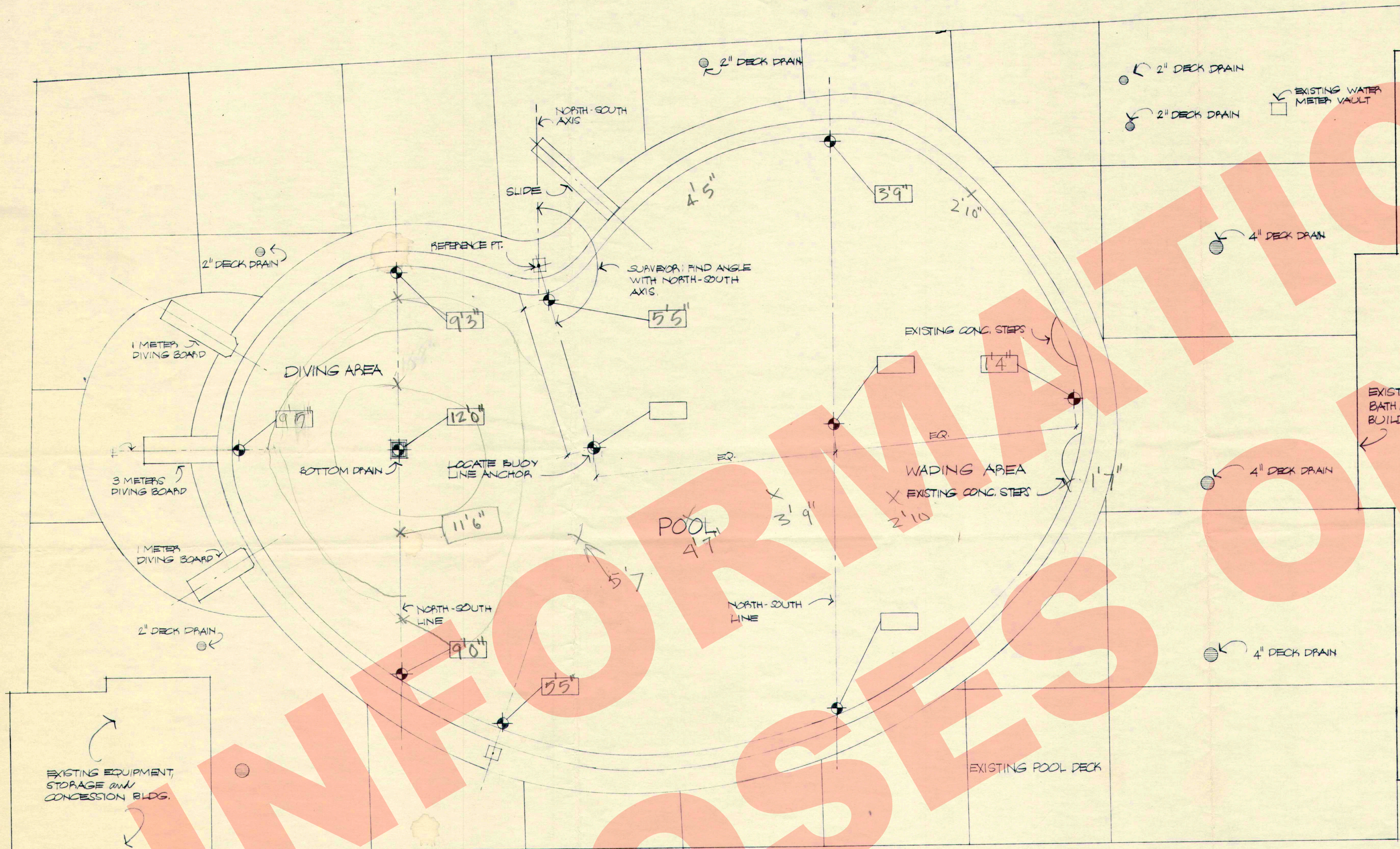

PLAN OF EXISTING POOL DECK  
SCALE 1" = 1' - 0"

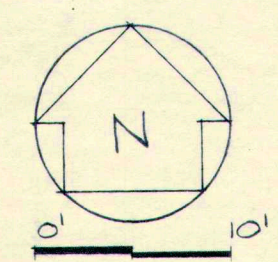

NOTE:  
SURVEYOR: INDICATE HEIGHT FROM  
BOTTOM OF POOL SLAB TO NORMAL  
WATER LEVEL FOR ALL LOCATIONS SHOWN  
WITH THE FOLLOWING SYMBOL

9-29-77  
PARK DEPT.  
SURVEYOR

LUFKIN SWIMMING POOL INSPECTION  
EXISTING FIELD CONDITIONS  
  
VILLAGE OF VILLA PARK RECREATION BOARD  
320 EAST WILDWOOD AVENUE  
VILLA PARK, ILLINOIS 60181

james follensbee & associates ltd.  
architects planners engineers  
311 west hubbard street · chicago  
illinois 60610 phone 467-4767

no.	date	revision	project number	7720
			drawing date	9-26-77
			drawn by	PVP
			checked by	JF
			approved for:	
			architect	JF
			owner	
			binding order	

EXISTING SITE  
ELEVATIONS

EC-1

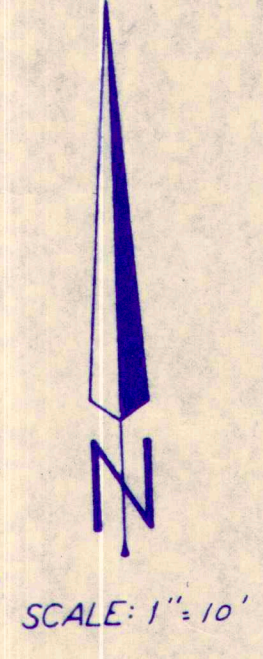
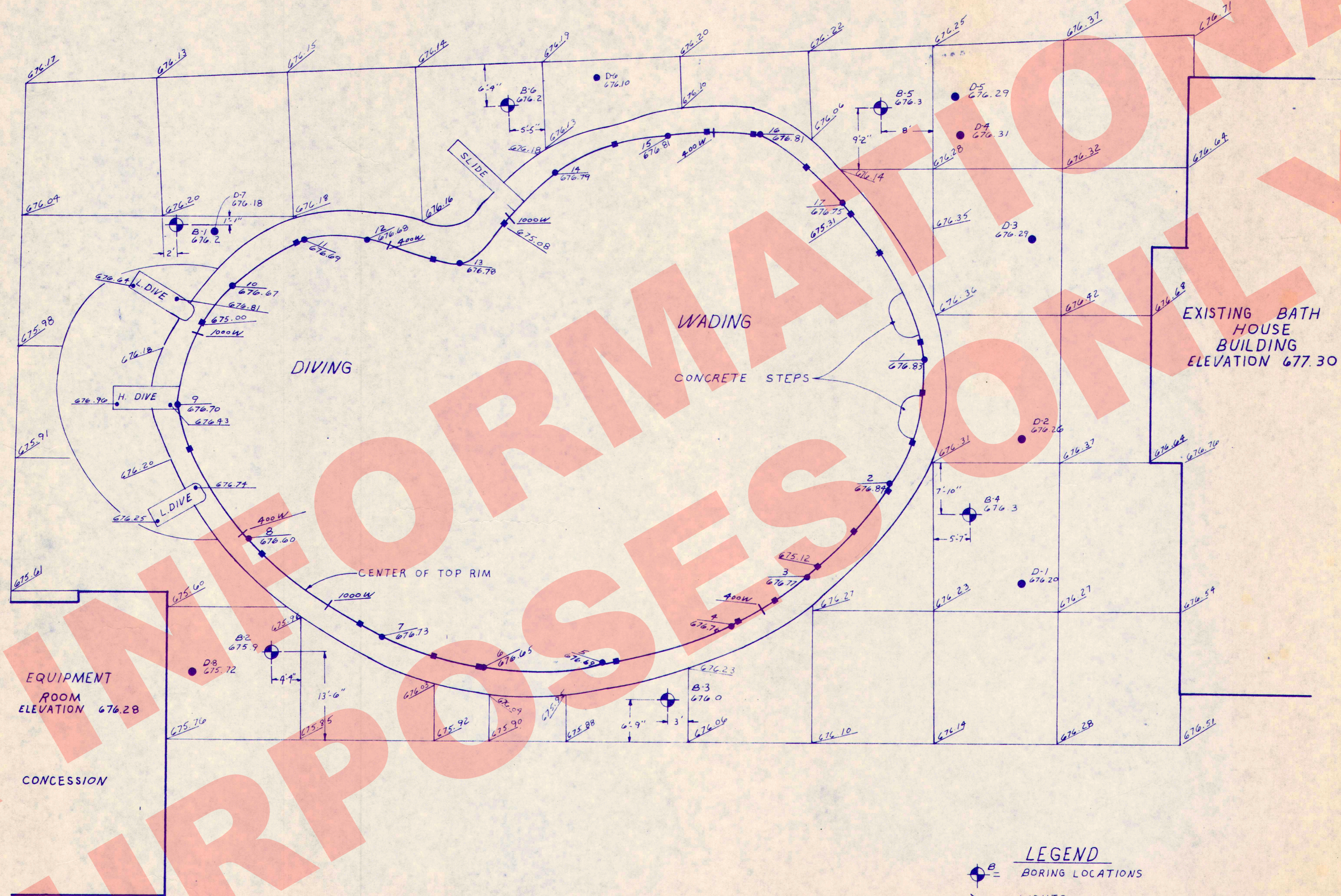

- LEGEND**
- B = BORING LOCATIONS
  - LIGHTS
  - SUPPLY INLETS
  - D = DRAINS

**BORING LOCATION PLAN**  
 LUFKIN SWIMMING POOL  
 ALTS.  
 VILLA PARK ILLINOIS

TESTING SERVICE CORPORATION  
 457 EAST GUNDERSEN DRIVE  
 WHEATON, ILLINOIS 60187  
 NOVEMBER 10, 1975 L-12,971